



Capsule Pressure Gauges

Black ABS Case
Copper Alloy Wetted Parts
Low Pressure Series • Type 611.16

Pressure Gauges

Application

Fluid medium, gaseous or dry, which does not clog connection port or corrode copper alloy.
Example: low pressure pneumatic systems.

Sizes

2½" (63 mm)

Accuracy

± 1.5% of span (± 2.5% for 10" H₂O range)

Ranges

10 "H₂O to 240 "H₂O (25 to 600 mbar)
or other equivalent units of pressure or vacuum

Working Range

Steady: Full scale value
Fluctuating: 0.9 x full scale value

Operating Temperature

Ambient: -4°F to 140°F (-20°C to 60°C)
Media: max. 140°F (+60°C)

Temperature Error

Additional error when temperature changes from reference temperature of 68°F (20°C) ±0.4% for every 18°F (10°C) rising or falling. Percentage of span.



Standard Features

Connection

Material: copper alloy
Lower mount (LM)
Center back mount (CBM)
1/8" NPT or 1/4" NPT

Capsule Element

Material: copper alloy

Movement

Copper alloy, nickel-silver pinion gear and shaft. Zero adjustment screw on dial

Dial

White aluminum with black lettering

Pointer

Black aluminum (Zero adjust on dial. Must remove window to access)

Case

Black ABS

Weather Protection

Dust resistant (NEMA 2 / IP 32)

Standard Scales

in. H₂O/mm H₂O
oz.-sq. in./mm H₂O
oz.-sq. in./in. H₂O
PSI

Window

Snap-in acrylic window

Order Options (min. order may apply)

Front flange
Brass threaded restrictor
U-Clamp
Stainless steel wetted parts (**Type 631.16**)
Overpressure and underpressure protection
Cleaned for oxygen service
Medical specification
Special connections limited to wrench flat area
Nickel plated connection
Externally adjustable red drag pointer (max. hand)
Red set pointer on dial
Custom dial layout
DIN standards
Other pressure scales available

APM 611.16
(APM 06.16)

Dimensions:

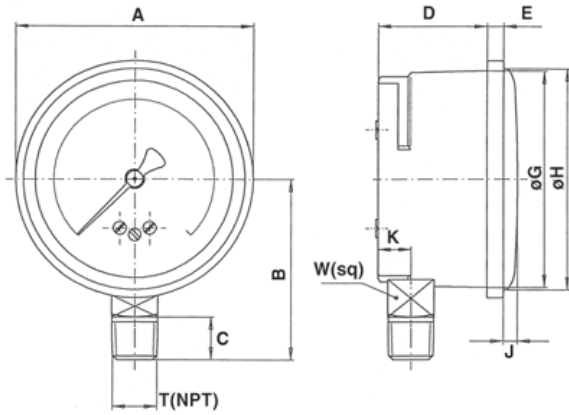

611.16 2 1/2" LM

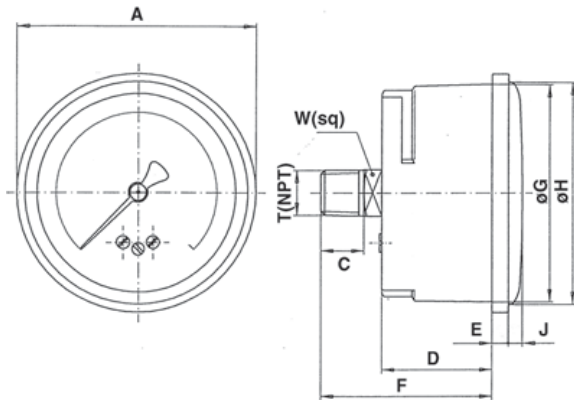
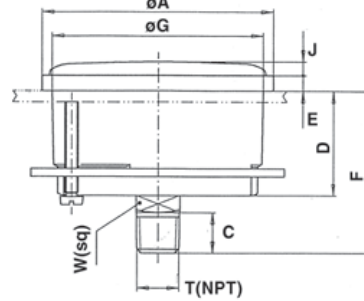

611.16 2 1/2" CBM

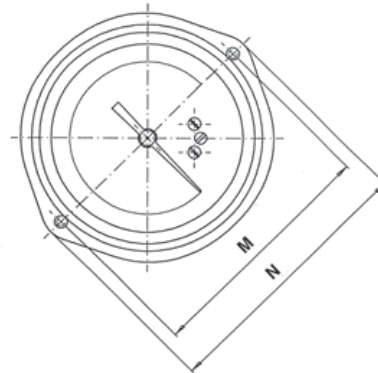

611.16 2 1/2" CBM/UC

A* NOMINAL SIZE

| TYPE | WEIGHT | KEY | A* | B | C | D | E | F | G | H | J | K | M | N | T | W |
|----------------|-----------|-----|------|------|------|-------|------|-------|------|------|------|------|------|------|------|------|
| 611.16 2.5" | 0.35 lbs. | mm | 72.2 | 55 | 13 | 33.15 | 4.85 | 51.55 | 65.9 | 67.4 | 4.3 | 10 | 76 | 85 | 1/4" | 14 |
| | | in | 2.84 | 2.17 | 0.52 | 1.31 | 0.19 | 2.03 | 2.59 | 2.65 | 0.17 | 0.39 | 2.99 | 3.35 | NPT | 0.55 |

Recommended panel cut-out: G + 1mm

**THE MEASURE OF
Total Performance™**

Ordering Information:

State computer part number (if available) / type number / size / range / connection size and location / options required.

Specifications given in this price list represent the state of engineering at the time of printing. Modifications may take place and the specified materials may change without prior notice



WIKAL Instrument Corporation

1000 Wiegand Boulevard

Lawrenceville, Georgia 30043-5868

Tel: 770-513-8200 Fax: 770-338-5118

http://www.wika.com e-mail: info@wika.com