

Bourdon Tube Pressure Gauges Solid-Front Process Gauge - Direct Drive Type 232.34DD

WIKA Datasheet 232.34DD

Applications

- Where high dynamic pressure pulsations or vibration exist
- Suitable for corrosive environments and gaseous or liquid media that will not obstruct the pressure system
- Process industry: chemical/petrochemical, power stations, mining, on and offshore, environmental technology, mechanical engineering and plant construction

Special features

- Excellent load-cycle stability and shock resistance
- Movement-less direct drive Bourdon tube
- Positive pressure ranges to 10,000 psi

Standard Features

Design

ASME B40.100

Sizes

4½" (115 mm) dial size

Accuracy class

± 0.5% of span (ASME B40.100 Grade 2A)

Ranges

Vacuum / Compound to 300 psi
Pressure from 15 psi to 10,000 psi
or other equivalent units of pressure or vacuum

Working pressure

Steady: full scale value
Fluctuating: 0.9 x full scale value
Short time: 1.5 x full scale value

Operating temperature

Ambient: -65°F to +190°F (-54°C to +88°C)
Medium: +265°F (+130°C) maximum

Temperature error

Additional error when temperature changes from reference temperature of 68°F (20°C) ±0.4% for every 18°F (10°C) rising or falling. Percentage of span.



Bourdon Tube Pressure Gauge Model 232.34DD

Weather protection

Weather resistant (NEMA 3 / IP54)

Pressure connection

Material: 316L stainless steel
Lower mount (LM)
1/4" or 1/2" NPT with M4 internal tap

Bourdon tube / wetted parts

Material: Inconel X-750
Silver solder
316SS socket & capillary

Dial

White aluminum with black lettering, stop pin at 6 o'clock

Pointer

Black aluminum, adjustable

Case

Yellow glass-reinforced thermoplastic (PBTP)
Solid front, blowout back
Turret-style case with built in rear flange lugs

Window

Clear acrylic with Buna-N gasket

Optional extras

- Threaded restrictor
- Panel mounting adaptor kit (field assembled)
- Cleaned to ASME B 40.100 level IV
- Special process connections
- Custom dial layout

Note: WIKA recommends the use of a gauge filter or separation/isolation device (snubber or seal) between the process media and gauge. All direct drive gauges are, by design, susceptible to system blockage from process media, due to low profile design and minimum bore diameter of the pressure measuring system.

Dimensions

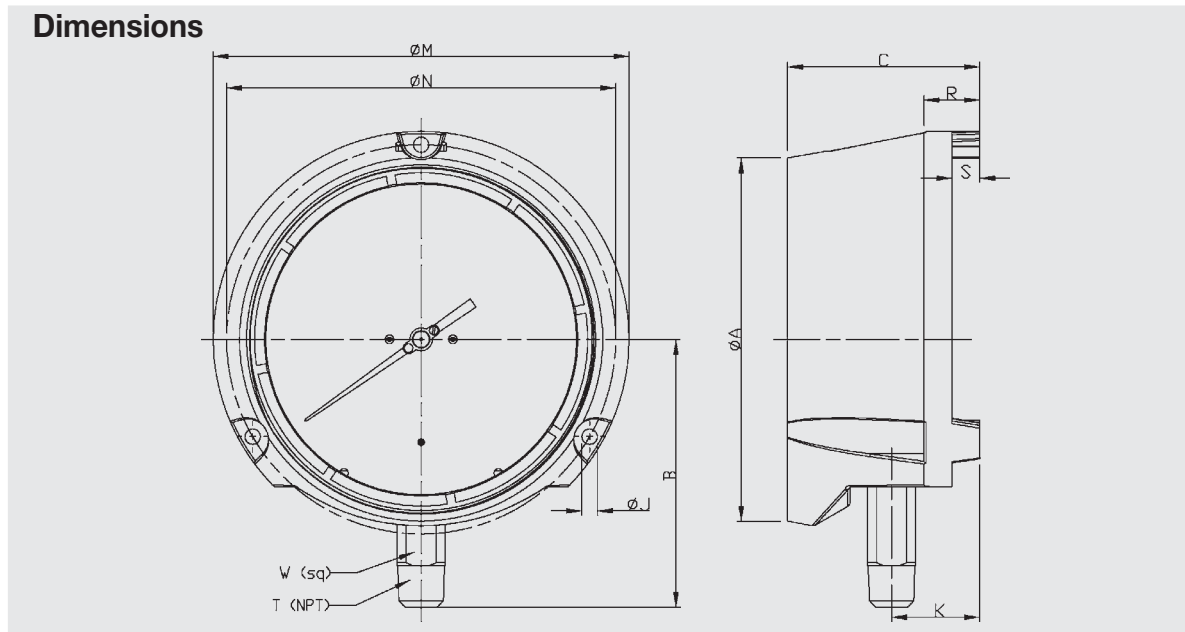

Size		A	B	C	D	J	K	L	M	N	R	S	T	W	Weight ¹
4.5"	mm	128	103	84	120.3	6.3	40	28.5	148	136.5	25	12.5		22	
	in	5	4.06	3.31	4.74	0.248	1.57	1.12	5.83	53.7	0.99	0.49	1/2"	0.87	2 lb.

¹ Weight without optional accessories

Ordering information

Pressure gauge model / Nominal size / Scale range / Size of connection / Optional extras required
 Specifications and dimensions given in this leaflet represent the state of engineering at the time of printing.
 Modifications may take place and materials specified may be replaced by others without prior notice.



WIKAL Instrument Corporation
 1000 Wiegand Boulevard
 Lawrenceville, GA 30045
 Tel (770) 513-8200 Toll-free 1-888-WIKA-USA
 Fax (770) 338-5118
 E-Mail info@wika.com
 www.wika.com