

# Bourdon Tube Pressure Gauge Type 111.12, 1" Mini Gauge Standard Series - Center Back Mount

WIKA Datasheet 111.12.1

## Applications

- Pneumatic control systems
- Pumps, water systems, regulators
- Suitable for fluid medium which does not clog connection port or corrode copper alloy

## Special features

- Copper alloy wetted parts
- Brass or ABS case
- Center back mount (CBM) process connection

## Standard Features

### Design

EN 837-1

### Sizes

1" (27 mm)

### Accuracy class

± 4% of span (± 3/2/3% available)

### Ranges (All ranges not stocked)

0/30 psi to 0/6,000 psi

### Working pressure

Steady: 3/4 of full scale value

Fluctuating: 2/3 of full scale value

Short time: full scale value

### Operating temperature

Ambient: -40°F to 140°F (-40°C to 60°C)

Media: 140°F (+60°C) maximum

### Temperature error

Additional error when temperature changes from reference temperature of 68°F (20°C) ±0.4% for every 18°F (10°C) rising or falling. Percentage of span.

### Pressure connection

Material: copper alloy, integral with case  
1/8" NPT center back mount (CBM)



Bourdon Tube Pressure Gauge Type 111.12 1"

### Bourdon Tube

Material: copper alloy  
30 psi to 400 psi C-type  
600 psi to 6000 psi helical type

### Movement

Copper alloy

### Dial

White plastic with stop pin and black lettering

### Pointer

Black ABS

### Case

Brass

### Window

Snap-in polycarbonate

## Optional Extras

- Accuracy  $\pm 3/2/3\%$  of span (ASME B40.100 Grade B)
- Nickel-plated case and socket
- Polyamide (PA) case material
- Special threaded connection
- Custom dial layout
- Other pressure scales available:  
bar, kPa, MPa, kg/cm<sup>2</sup> and dual scales

## Dimensions

### Standard version

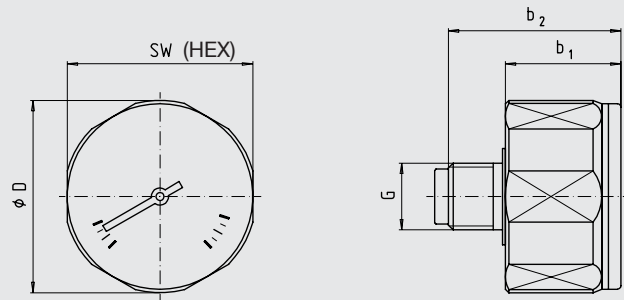

Size		SW	b1	b2	øD	G	Weight
1"	mm	27	17±0.5	27±1	28		
	in	1.06	0.67±.02	1.06±.04	1.10	1/8"NPT	0.08 lb

#### Ordering information

Pressure gauge model / Nominal size / Scale range / Size of connection / Optional extras required  
 Specifications and dimensions given in this leaflet represent the state of engineering at the time of printing.  
 Modifications may take place and materials specified may be replaced by others without prior notice.



**WIKAL Instrument Corporation**  
 1000 Wiegand Boulevard  
 Lawrenceville, GA 30045  
 Tel (770) 513-8200 Toll-free 1-888-WIKA-USA  
 Fax (770) 338-5118  
 E-Mail info@wika.com  
 www.wika.com