

Bourdon Tube Pressure Gauge

Model 101.12 LBM, All Stainless Steel Construction

WIKA Datasheet 101.12

Applications

- Air pumps, Compressors
- Pneumatic, pesticide & medical equipment
- Suitable for gas or fluid which does not clog connection port or corrode Polyamid (PA) or copper alloy

Special features

- OEM Version
- Center Back Mount (CBM)
- All Stainless steel construction



Standard version

Design

OEM Version

Size

1" (27mm)

Accuracy class

± 4% of span (± 3/2/3% available)

Bourdon Tube

Material: Copper alloy
C-type

Movement

Copper alloy

Dial

White plastic with stop pin and black lettering

Pointer

Black ABS plastic

Case

Fiberglass-reinforced polyamid (PA 66)

Standard Scale

PSI, Bar or other standard unit

Scale of dial

270° dial arc

Pressure Gauge 101.12

Window

Snap-in polycarbonate

Working Range

Steady: 3/4 of full scale value
Fluctuating: 2/3 of full scale value
Short time: full scale value

Operating Temperature

Ambient: 32°F to 140°F (0°C to 60°C)
Media: max. 140°F (+60°C)

Temperature error

Additional error when temperature changes from reference temperature of 68°F (20°C) ±0.4% for every 18°F (10°C) rising or falling. Percentage of span.

Connection

Fiberglass-reinforced Polyamid (PA 66)
Center back mount (CBM)
1/8" NPT

Optional Extras

- Custom dial layout
- Special threaded connection
- 1000 pcs. per line item

Dimensions

Standard versions

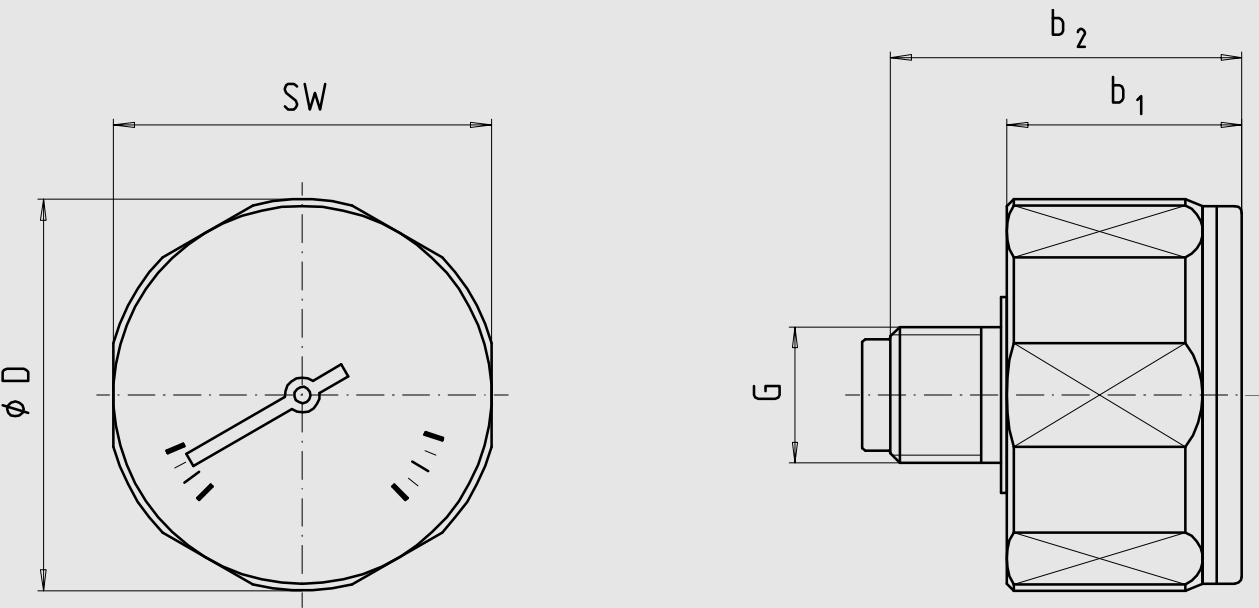

A* NOMINAL SIZE

TYPE/SIZE	WEIGHT	KEY	A*	C	D	G	T
101.12 1"	0.03 lbs.	mm	27	16.5 ±0.5	28	27 ±1	1/8" NPT
		in	1.06	0.65 ±0.02	1.10	1.06 ±0.04	

Ordering information
State computer part number (if available) /type number/size/range/connection size and locations/options required. WIKA reserves the right to make changes without prior notice.



WIKA Instrument Corporation
1000 Wiegand Boulevard
Lawrenceville, GA 30043
1-888-WIKA-USA /770-513-8200 (in GA)
Fax 770-338-5118
info@wika.com www.wika.com

